

PCB Connector — TLP series ( Pin header )— TLPHDC-010V-XXP-HT

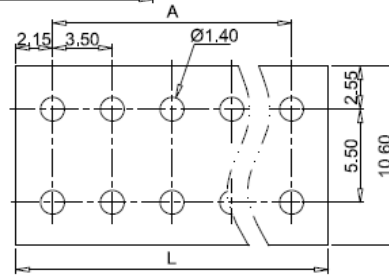
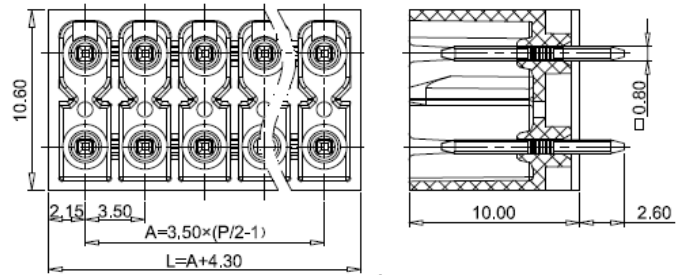
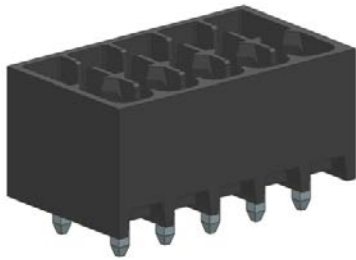

PCB LAYOUT

■ 图示(Pic. shown) : TLPHDC-010V-10P-HT-K

General.	PCB Connector Rated : 160V,10A
	Single row , 3.50mm pitch , 04-48 Pole
	Orientation:90°(plug-in to board)

认证 ( Approval ) Applying

技术参数 Technical Data	UL standard			IEC standard		
UL应用组别(UL Application group)	UL Application group			IEC过电压别/污染等级(IEC overvoltage category /pollution degree)		
IEC过电压别/污染等级(IEC overvoltage category /pollution degree)	B	C	D	III / 3	III / 2	II / 2
额定电压(Rated voltage)	300V	50V	300V	--	160V	--
额定电流(Rated current)	8A	8A	8A	--	10A	--
额定连接容量(Rated connection capacity)	--			--		
绝缘材料(Insulation Material)	PA9T/LCP UL94 V-0					
电流承载部件材料和镀层 ( Material & Plating of Current carrier )	Copper alloy , Tin plated					
接线弹片材料(Material of Clamp spring )	--					
绝缘电阻(Insulation Resistance)	500MΩ or more at DC500V					
耐电压(1分钟)(Withstanding Voltage/1Min)	1600V					
额定冲击电压(Rated surge voltage)	2500V					
接线螺丝(Wire clamp unit Screw) , 最大扭矩( torque Max. )	--					
固定螺丝(Mounting Screw) , 扭矩(torque)	--					
剥线长度(Wire stripping length)						
使用温度(Operating temperature)	-40°C up to +130°C					
焊接方式(Soldering recommend)	Wave soldering & Reflow soldering ( THR ) capable					

■ 订购方式(How to order)

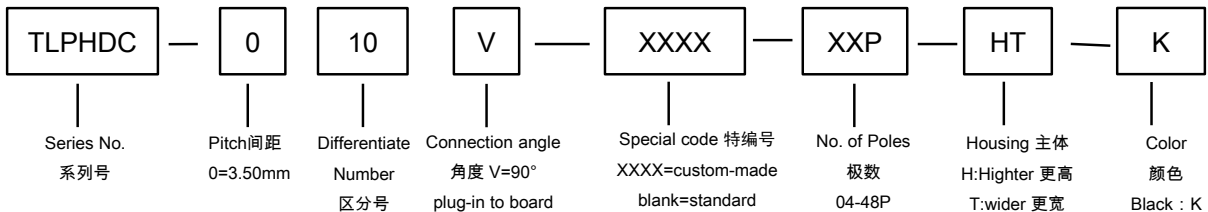

■ 插头 ( Female Connector ) -dual row in 1 plane



P/N : TLPSD-010

Wiring orientation :

180°(wire to plug-in )

Rated : 160V,10A , 1.5mm<sup>2</sup>

Spring clamp unit.